



RETAIL PRICE LIST 2023

AUSTRALIA

ISSUE 2023-2



Connect with us via



13 22 12

National Number

augertorque.com.au



OUR VALUES

or HOW TO **be...**

be GLOBAL

Supporting customers around the world
Sharing the best ideas between us all
Grow business, partnerships and people



Fast to respond and deliver quality quickly
Practical solutions from experts
Protect the 'Auger Feel'

Positive and honest relationships
Do what we promised
Understand needs of customers,
employees and stakeholders

be NIMBLE

be OPEN

2023 PRICE LIST INDEX

S2 EARTH DRILLS - MICRO EXCAVATORS UP TO 1T

Page 8	S2 Earth Drills & S2 Earth Drill Hitches
Page 9	S2 Augers & S2 Wear Parts

S4 EARTH DRILLS - MINI EXCAVATORS 1-5T, MINI LOADERS & SKIDSTEERS UP TO 80HP

Page 10	S4 Earth Drills & S4 Earth Drill Frames
Page 11	S4 Earth Drill Hitches
Page 12	S4 Augers
Page 13	S4 Wear Parts & Extensions & Clean Out Discs

S5 EARTH DRILLS - EXCAVATORS 4.5-8T, BACKHOES, HIGH FLOW SKIDSTEERS & TELEHANDLERS

Page 14	S5 Earth Drills & S5 Earth Drill Frames
Page 14-15	S5 Earth Drill Hitches
Page 16	S5 Augers
Page 17	S5 Extensions, S5 Clean Out Discs & S5 Wear Parts

S6 EARTH DRILLS - EXCAVATORS FROM 8-22T & BACKHOES

Page 18	S6 Earth Drills
Page 18-19	S6 Earth Drill Hitches
Page 20	S6 Augers
Page 21	S6 Extensions, S6 Clean Out Discs & S6 Wear Parts

PA EARTH DRILLS RANGE - EXCAVATORS FROM 17-45T

Page 22	PA Earth Drills & PA Earth Drill Hitches
Page 22-23	PA Augers
Page 23	PA Extensions & Clean Out Discs
Page 23	PA Wear Parts

SCREW PILE EARTH DRILLS RANGE - EXCAVATORS FROM 21-50T

Page 24	Screw Pile Earth Drills
Page 24	Screw Pile Earth Drill Cradle Hitch Sections
Page 24	Screw Pile Earth Drill Hubs & Pins
Page 24	Screw Pile Earth Drill Accessories

AUGER TORQUE TRENCHERS

Page 26-28	MT Trencher Range - to suit Mini Excavators from 2.5-5T, Mini Loaders & Skidsteer Loaders up to 80HP
Page 29-31	XHD Trencher Range - to suit Excavators from 5-10T, High Flow Skidsteer Loaders & Backhoes.
Page 32	Non Universal Trencher Frames & Trencher Wear Parts

VARIOUS ATTACHMENTS & ACCESSORIES

Page 33	Mixer Bowls & Hedge Trimmers, Hitches, Spare & Wearparts
Page 34	Alignment Monitor, Mulchers, Cone Crusher Bucket, Stump Planers & Log Splitters
Page 35	Spreader Bars, Pallet Forks & Aluminium Loading Ramps
Page 36	Drum Cutters
Page 37	Auger Shaft Adapters & Auger Hubs - Male & Female
Page 38	Hydraulic Couplers, Hydraulic Hoses, Link Blocks, Clips & Pins

EARTH DRILL SPECIFICATIONS

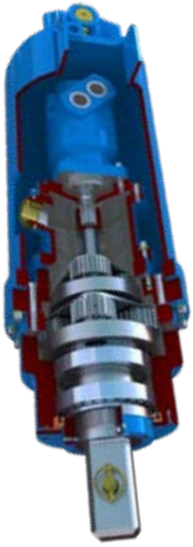

Model	Flow (lpm)	Pressure (Bar)	Speed (rpm)	Torque (Nm)
Mini loader 1500	20-45	70-205	44-98	511-1,496
Mini loader 2000	25-57	70-240	43-99	639-2,190
Mini loader 2500	27-65	70-240	36-87	830-2,847
1200	15-32	30-185	41-88	191-1,178
X1500	20-45	70-205	44-98	511-1,496
X2000	25-57	70-240	43-99	639-2,190
X2500	27-65	70-240	36-87	830-2,847
3000	27-75	80-240	36-100	959-2,877
3000TC	5-35	80-260	7-46	959-3116
3500	40-85	80-240	42-90	1,205-3,614
4500	50-95	80-240	43-81	1,500-4,499
5000	50-95	80-260	40-76	1582-5142
5500MAX	40-115	80-260	27-78	1,685-5,477
5500TC	15-50	80-260	11-38	1685-5477
7000MAX	60-135	80-260	36-81	2,133-6,931
7000TC	15-50	80-260	9-30	2098-6819
8000MAX	70-150	80-240	33-70	2,717-8,152
10,000	70-150	80-260	27-58	3,281-10,662
15,000MAX	80-170	80-240	20-43	5,024-15,071
20,000MAX	80-170	160-240	16-33	13,043-19,564
25,000MAX	80-170	160-240	12-26	16,503-24,755
35,000MAX	80-225	180-310	11-31	20,510-35,323
42,000MAX	80-225	180-301	9-26	24,612-42,387
65,000MAX	100-280	160-320	8-21	33295-66589
100,000MAX	100-280	160-350	5-15	45,746 -100,069
150,000MAX	100-340	160-340	4-12	71,680-152,319

AUGER SPECIFICATIONS



Auger Series	Machine Weight	Auger Length	Flight Thickness	Std Hub
S2	0.75-1T	0.9m	5mm	50mm Rnd
S4	1-5T	1.2m	6mm	65mm Rnd
S5	4.5-8T	1.5m	8mm	75mm Sq
S6	8-22T	1.8m	12mm	75mm Sq
PA	17-45T	2.3m	12-20mm	110mm Sq



PRODUCT DEFINITIONS

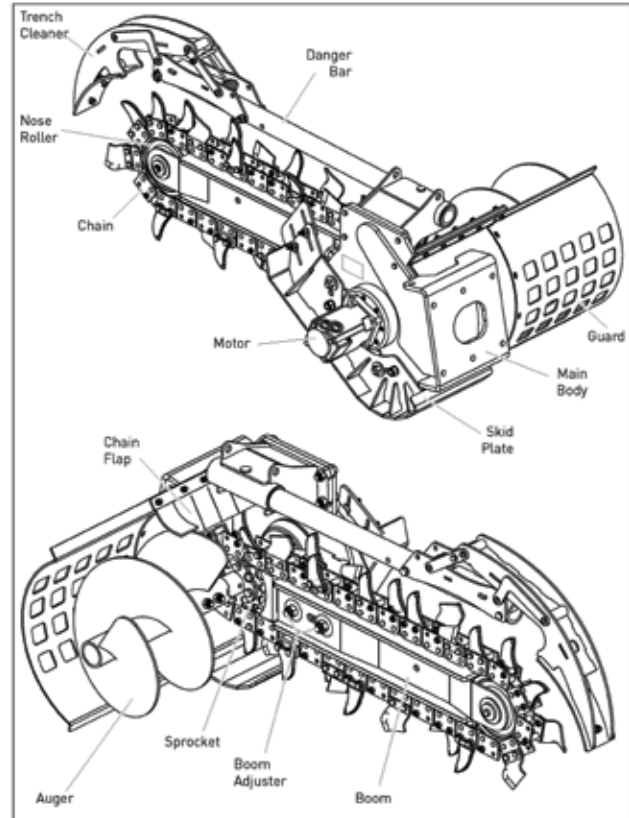
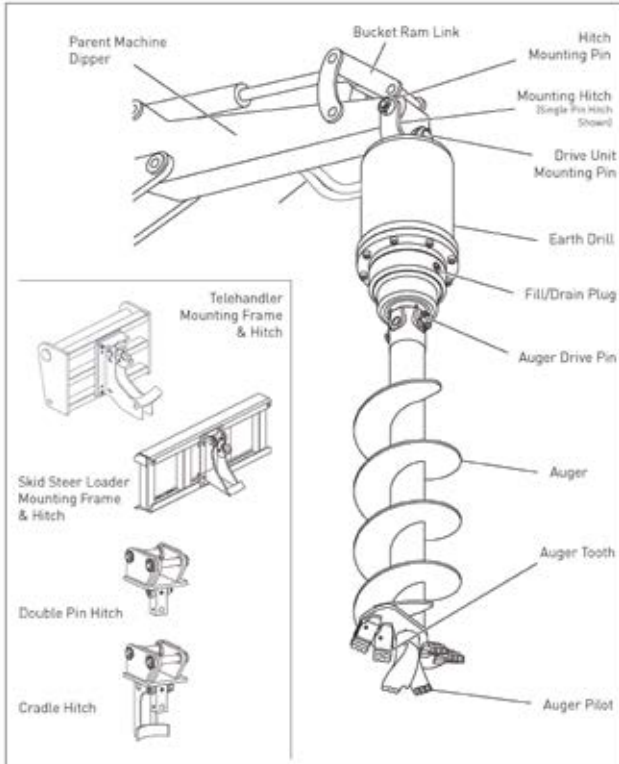

HYDRAULIC HOSE FITMENT



WARNING:

Hydraulic fluid under pressure can penetrate the skin or eyes and cause serious personal injury, blindness or death. Fluid leaks under pressure may not be visible. Use a piece of card or wood to find leaks. **DO NOT** use your bare hands. Wear safety goggles to protect your eyes. If any fluid is injected into the skin, it **MUST** be surgically removed. Seek immediate medical attention.

All Auger Torque Earth Drill Units require a 'flow' and 'return' of hydraulic oil from the parent machine's auxiliary hydraulic power supply to operate. The oil should be clean and free of contaminants such as water, dust and particulates. Auger Torque products require oil fluid cleanliness to meet or exceed: ISO Code 20/18/13 (ISO4406) to satisfy warranty requirements. All gearboxes are reversible, but require the host machine to be fitted with a two-way flow auxiliary circuit. (Check with parent machine dealer for advice).

When fitting hydraulic hoses, ensure that they are tightened to the correct torque for the hose fittings (Fig A).

Quick Release Couplers are required for connection to the parent machine, but may not be supplied with the unit. These can be sourced locally and should be compatible with the auxiliary hydraulic Quick Release Couplers on the parent machine (Figs B & C). The parent machine auxiliary hydraulic connections are normally located near the end of the loader arms, excavator dipper or truck crane booms.

Ensure that the drilling rotation of the Earth Drill Unit is clockwise.

It is critical that the supply of oil is within the stated flow & pressure limits for the particular Earth Drill;

Refer to the serial plate on the top of the Earth Drill hood (see page 4).

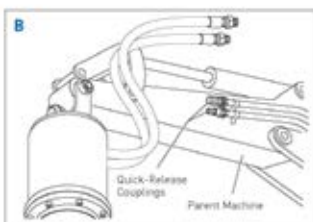

Case drain line fitting

Some of the larger Auger Torque Earth Drills are fitted with a case drain line.

This is a flexible hose protruding from the Earth Drill hood and must be connected to a line that returns to the machine's hydraulic fluid reservoir. The parts required to complete this circuit will vary, depending on the machine and the hydraulic equipment fitted. Consequently, case drain hose fittings are not supplied with the Earth Drill and must be sourced separately.

When fitting a case drain line, there must be no restrictions to the flow between the Earth Drill and the reservoir. You **MUST** not use quick release couplings.

You may receive an installation form with your unit, this form must be completed and returned to Auger Torque to validate the warranty.

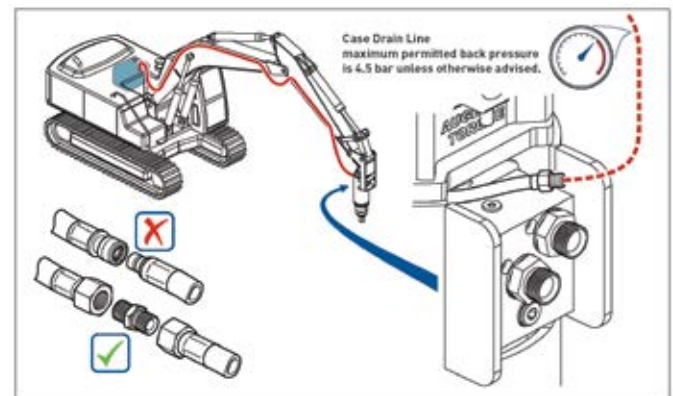

EARTH DRILL MAINTENANCE

RUNNING-IN

To maximise the life of the unit, it must be run in for a period.

To carry out the running in procedure, suspend the Earth Drill in its vertical, working position.

For the duration of the running in procedure, ensure there are no bystanders within the nominated radius as defined in the risk assessment completed prior to commencing any works.

Operate the motor at 30% of rated pressure for 20 minutes in each direction before application of full operating load.

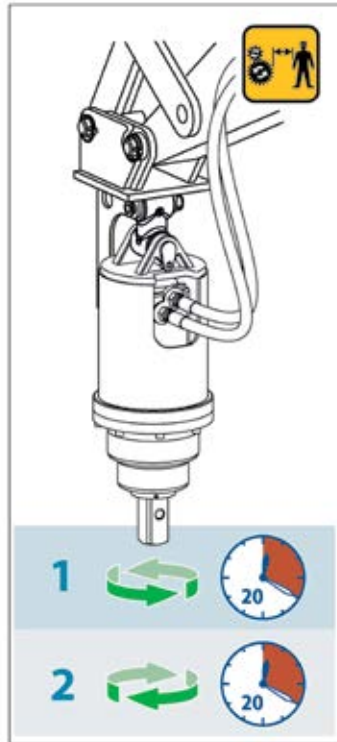

Service Intervals

Your Auger Torque Europe Ltd Earth Drill Unit features a sealed gear housing filled with gear oil to lubricate the planetary gearset components and bearings within the housing.

Auger Torque Europe Ltd Earth Drill Units are low maintenance, however regular checks for oil leaks and following the service schedules are recommended to ensure a trouble free product.

Weekly:

Grease hitch and Earth Drill pivot pins.

Oil Lubrication

Your Earth Drill has been prefilled with Gear Oil. This oil requires regular changing. Changing the oil at regular intervals will prolong the life of the unit.

Important

To maintain product warranty, your Auger Torque Dealer **MUST** record proof of each oil change.

Please have your Earth Drill serviced as specified in the chart overleaf by an **Authorised Auger Torque service representative**

Make sure that each service is documented in the Service Record section of this manual to ensure product warranty is retained and the product life is extended.

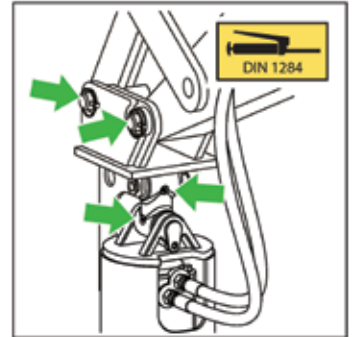

WEAR PART MAINTENANCE

Component Wear

The cutting teeth and pilots should be checked regularly for wear. The diagrams below show acceptable levels of wear.

NOTE: Excessively worn teeth & pilots may cause damage to the Auger

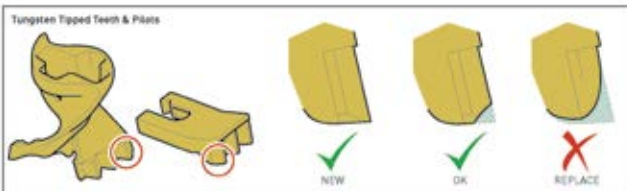
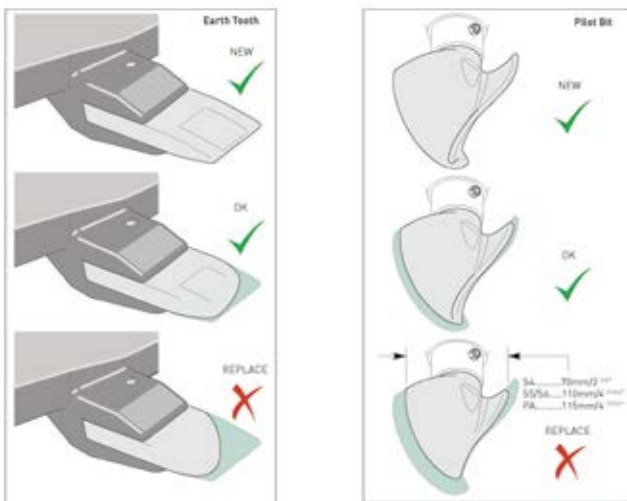

Cutting Tooth Maintenance

To cope with different types of trenching conditions, Auger Torque trenching chains are supplied fitted with interchangeable 'Earth' or 'Tungsten' teeth, or a combination of both types (Fig A).

The teeth are bolted directly to the chain, or with spacers to provide a range of trench widths.

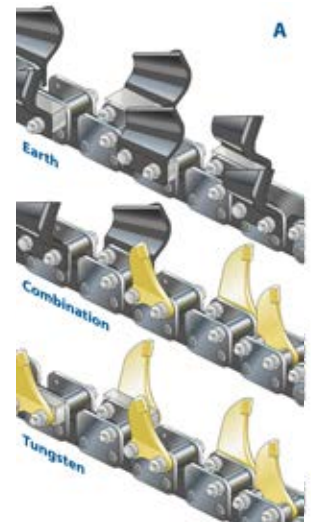

After prolonged use, the cutting teeth will show signs of wear and eventually become inefficient.

Fig B shows acceptable levels of wear for the earth teeth.

Tungsten tooth wear limits are shown in Fig C.

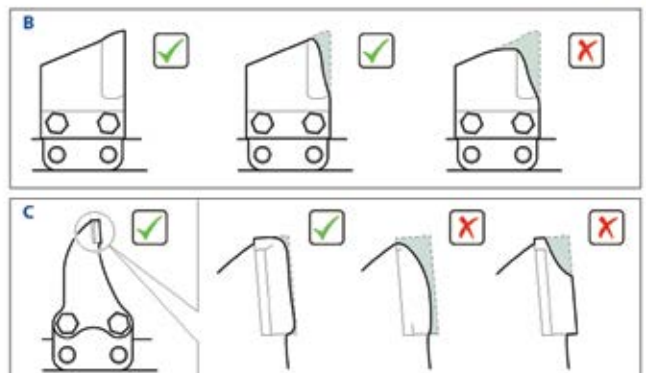

RECOMMEND OIL CHANGE INTERVALS

Oil change frequency		
Model	First oil change after initial use	Subsequent oil change frequency
1200 / 900-9	3 Months or 200 hours*	12 Months or 800 hours*
X1500 / X1100-13	3 Months or 200 hours*	12 Months or 800 hours*
X2000 / X1600-15	3 Months or 200 hours*	12 Months or 800 hours*
X2500 / X2100-17	3 Months or 200 hours*	12 Months or 800 hours*
ML1500 / ML1100-13	3 Months or 200 hours*	12 Months or 800 hours*
ML2000 / ML1600-15	3 Months or 200 hours*	12 Months or 800 hours*
ML2500 / ML2100-17	3 Months or 200 hours*	12 Months or 800 hours*
3000TC / 2300-10	3 Months or 200 hours*	12 Months or 800 hours*
3000MAX / 2200-20	3 Months or 200 hours*	12 Months or 800 hours*
3500MAX / 2700-25	3 Months or 200 hours*	12 Months or 800 hours*
4500MAX / 3300-30	3 Months or 200 hours*	12 Months or 800 hours*
5000 / 3700-30	3 Months or 200 hours*	12 Months or 800 hours*
5500TC / 4000-14	3 Months or 200 hours*	12 Months or 800 hours*
5500MAX / 4000-30	3 Months or 200 hours*	12 Months or 800 hours*
7000 / 5000-30	3 Months or 200 hours*	12 Months or 800 hours*
7000TC / 5000-14	3 Months or 200 hours*	12 Months or 800 hours*
7000MAX / 5200-35	2 Months or 120 hours*	12 Months or 800 hours*
8000MAX / 6000-40	2 Months or 120 hours*	12 Months or 800 hours*
10000 / 8000-40	2 Months or 120 hours*	12 Months or 800 hours*
12000 / 9500-40	2 Months or 120 hours*	12 Months or 800 hours*
12000MAX / 9000-45	2 Months or 120 hours*	12 Months or 800 hours*
15000 / 11000-40	2 Months or 120 hours*	12 Months or 800 hours*
15000MAX / 11000-45	2 Months or 120 hours*	12 Months or 800 hours*
17000MAX / 12500-45	1 Month or 50 hours*	4 Months or 200 hours*
20000MAX / 15000-45	1 Month or 50 hours*	4 Months or 200 hours*
25000MAX / 18500-45	1 Month or 50 hours*	4 Months or 200 hours*
30000 / 20000-45	1 Month or 50 hours*	4 Months or 200 hours*
30000MAX / 24000-80	1 Month or 50 hours*	4 Months or 200 hours*
35000MAX / 26000-60	1 Month or 50 hours*	4 Months or 200 hours*
40000 / 32000-45	1 Month or 50 hours*	4 Months or 200 hours*
42000MAX / 31000-60	1 Month or 50 hours*	4 Months or 200 hours*
50000MAX / 35000-80	1 Month or 50 hours*	4 Months or 200 hours*
65000MAX / 48000-80	1 Month or 50 hours*	4 Months or 200 hours*
100000MAX / 74000-75	1 Month or 50 hours*	4 Months or 200 hours*
150000MAX / 110000-35	1 Month or 50 hours*	4 Months or 200 hours*
150XHT / 110XHT	1 Month or 50 hours*	4 Months or 200 hours*
250XHT / 185XHT	1 Month or 50 hours*	4 Months or 200 hours*

* Whichever time period occurs first.

Please refer to your user manual for recommended grade, type & volume

S2 RANGE EARTH DRILLS

50mm Round



Earth Drill 1200

Description	Part Number	RRP
EARTH DRILL 1200	21-10105F1000R2701	\$1,701.00

For flow & pressure information please refer to the table on page 4.

All Earth Drills include Flat Face Couplers and Hydraulic hoses. Advise requirements at time of purchase.*

SINGLE PIN HITCHES



Single Pin Hitch

Pin Diameter	Part Number	RRP
25mm PIN	11-302500-1200	\$236.00
30mm PIN	11-303000-1200	\$243.00

DOUBLE PIN HITCHES



Double Pin Hitch

Pin Diameter	Part Number	RRP
25mm PIN	12-302510	\$519.00
30mm PIN	12-303010	\$529.00



S2 AUGERS

50mm Round - Flat Tungsten Teeth, Flat Tungsten Chisel Teeth & Flat Tungsten Pilot

Auger Size	Part Number	RRP
S2 100mm	30-20102100	\$393.00
S2 150mm	30-20152100	\$458.00
S2 200mm	30-20202100	\$478.00
S2 225mm	30-20232100	\$516.00
S2 250mm	30-20253100	\$548.00
S2 300mm	30-20303100	\$592.00

5mm Flight Thickness, 900mm Overall Length, optional specifications incl. hub options available on request.

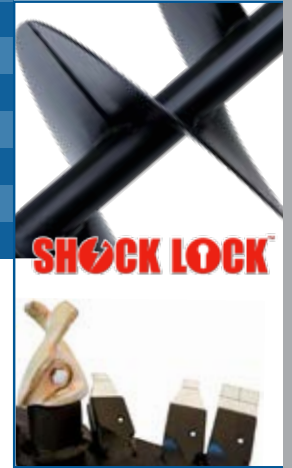

S2 WEAR PARTS

Description	Part Number	RRP
TOOTH - S4 SHOCK LOCK FLAT TUNGSTEN (B)	33-9124-KIT	\$38.00
TOOTH - S4 SHOCK LOCK FLAT TUNGSTEN CHISEL (C)	33-9123-KIT	\$27.00
PILOT - S4 FLAT TUNGSTEN (A)	33-9222-KIT	\$87.00
POCKET - S4 SHOCK LOCK	33-1010	\$27.00
DRIVE LUG - UP TO 250mm (42mm dia)	33-4105	\$39.00
DRIVE LUG - 300mm & ABOVE (60mm dia)	33-4102	\$38.00

All Shock Lock™ teeth come with rubber & pin, all pilots come with nut & bolt.



A



B



C



S4 RANGE EARTH DRILLS

65mm Round

Earth Drill 4500 MAX



Description	Part Number	RRP
EARTH DRILL MINI LOADER 2000	21-22008F1100R1701	\$2,194.00
EARTH DRILL MINI LOADER 2500	21-22108F1100R1701	\$2,224.00
EARTH DRILL X1500	21-20005F1000R1001	\$2,063.00
EARTH DRILL X2000	21-20105F1100R1001	\$2,241.00
EARTH DRILL X2500	21-20205F1100R1001	\$2,275.00
EARTH DRILL 2500	21-20303F1100R1001	\$2,322.00
EARTH DRILL 3000 MAX	21-23203F1100R1001	\$2,476.00
EARTH DRILL 3000 (Truck Crane only)	21-3370000400R1001	\$3,348.00
EARTH DRILL 3500 MAX	21-23303F1100R1001	\$2,618.00
EARTH DRILL 4500 MAX	21-33503F1100R1001	\$2,744.00

For flow & pressure information on each drive please refer to the table on page 4.

All Earth Drills include Flat Face Couplers and Hydraulic hoses. Advise requirements at time of purchase.*

MOUNTING FRAMES

Universal Skidsteer Loaders Frames

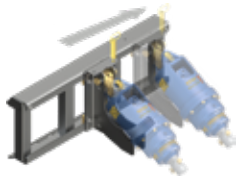

Universal Slide Mount Earth Drill frame to Suit Skidsteer Loader

Description	Part Number	RRP
Universal Slide Mount Frame - suit X1500 to X2500	19-9033-178	\$878.00
Universal Slide Mount Frame - suit 2500 to 4500MAX	19-9033-219	\$878.00

Euro Frame for Ag-Machinery

Description	Part Number	RRP
Euro Slide Mount Frame - suit X1500 to X2500	19-9037-178	\$973.00
Euro Slide Mount Frame - suit 2500 to 4500MAX	19-9037-219	\$989.00

To suit Skidsteer Loaders 2500 to 4500 MAX

Description	Part Number	RRP
Avant / Multi-One Centre Mounth Earth Drill Frame	19-9003	\$623.00
ASV RC30 & PT30 Centre Mount Earth Drill Frame	19-9024-219	\$1,032.00
Bobcat 463/S70 Centre Mount Earth Drill Frame	19-9048-219	\$1,032.00
Mustang Single Pin Centre Mount Earth Drill Frame	19-9056-219	\$1,104.00
New Holland L555 Centre Mount Earth Drill Frame	19-9060-219	\$1,032.00
Toyota 4SDK8 & 5SDK8 Centre Mount Earth Drill Frame	19-9062-219	\$1,032.00
Toyota 4SDK4 Centre Mount Earth Drill Frame	19-9064-219	\$1,032.00
Toyota 5SDK5 Centre Mount Earth Drill Frame	19-9066-219	\$1,032.00
Toyota 5SDK9 Centre Mount Earth Drill Frame	19-9068-219	\$1,032.00
Toyota 5SDK10 Centre Mount Earth Drill Frame	19-9070-219	\$1,032.00
Toyota 5SDK11 Centre Mount Earth Drill Frame	19-9072-219	\$1,032.00
JCB Q-FIT Telehandler Slide Mount Earth Drill Frame	19-9057-219	\$1,439.00
Cradle Section only - Earth Drill 2500 to 4500MAX	19-9034-219-SID	\$458.00

To suit Mini Loader Earth Drills

Mini Loader Earth Drill frame 4-Way Swing



Description	Part Number	RRP
FRAME - EARTH DRILL - MINI LOADER - 2 WAY SWING	16-9001	\$594.00
FRAME - EARTH DRILL - MINI LOADER - 4 WAY SWING	16-9009	\$658.00
FRAME - AVANT/MULTI ONE CENTRE MOUNT -2 WAY SWING	16-9003	\$623.00

SINGLE PIN HITCHES

To suit X1500 to 4500 MAX

Pin Diameter	Part Number	RRP
25mm PIN	11-302500	\$243.00
30mm PIN	11-303000	\$249.00
32mm PIN	11-303200	\$263.00
35mm PIN	11-303500	\$277.00
38mm PIN	11-303800	\$280.00
40mm PIN	11-304000	\$290.00
45mm PIN	11-304500	\$460.00



Single Pin Hitch

DOUBLE PIN HITCHES

To suit X1500 to 4500 MAX

Pin Diameter	Part Number	RRP
25mm PIN	12-302530	\$519.00
30mm PIN	12-303030	\$529.00
32mm PIN	12-303230	\$686.00
35mm PIN	12-303530	\$686.00
38mm PIN	12-303830	\$726.00
40mm PIN	12-304030	\$726.00
45mm PIN	12-304530	\$857.00



Double Pin Hitch

DOUBLE PIN CRADLE HITCHES

To suit X1500 to X2500

Pin Diameter	Part Number	RRP
25mm PIN	13-302520	\$730.00
30mm PIN	13-303020	\$740.00
32mm PIN	13-303220	\$899.00
35mm PIN	13-303520	\$899.00
38mm PIN	13-303820	\$937.00
40mm PIN	13-304020	\$937.00



Double Pin Cradle Hitch

To suit 2500 to 4500MAX

Pin Diameter	Part Number	RRP
30mm PIN	13-303030	\$774.00
32mm PIN	13-303230	\$935.00
35mm PIN	13-303530	\$935.00
38mm PIN	13-303830	\$971.00
40mm PIN	13-304030	\$971.00
45mm PIN	13-304530	\$1,104.00



S4 AUGERS

65mm Round - Tungsten Teeth, Tungsten Chisel Teeth & Tungsten Pilot

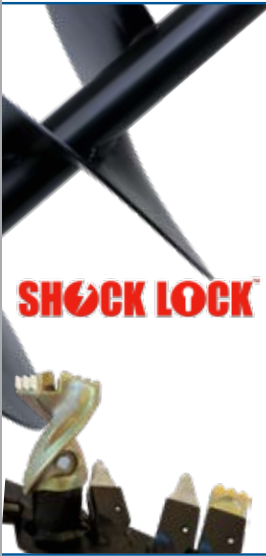

Auger Size	Part Number	RRP
S4 100mm	30-40105200	\$559.00
S4 150mm	30-40155200	\$633.00
S4 200mm	30-40205200	\$656.00
S4 225mm	30-40235200	\$682.00
S4 250mm	30-40254200	\$717.00
S4 300mm	30-40304200	\$765.00
S4 350mm	30-40354200	\$794.00
S4 400mm	30-40404200	\$863.00
S4 450mm	30-40454200	\$977.00
S4 500mm	30-40504200	\$1,045.00
S4 600mm	30-40604200	\$1,219.00
S4 750mm	30-40754200	\$1,513.00
S4 900mm	30-40904200	\$1,827.00

6mm Flight Thickness, 1.2m Overall Length, optional specifications incl. hub options available on request.

65mm Round - Rock Teeth & Rock Pilot

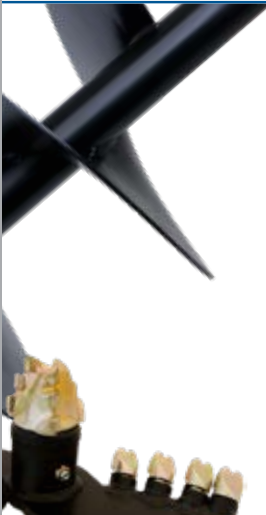

Auger Size	Part Number	RRP
S4 150mm	30-40157200	\$685.00
S4 200mm	30-40207200	\$819.00
S4 225mm	30-40237200	\$864.00
S4 250mm	30-40257200	\$925.00
S4 300mm	30-40307200	\$971.00
S4 350mm	30-40357200	\$1,074.00
S4 400mm	30-40407200	\$1,110.00
S4 450mm	30-40457200	\$1,206.00
S4 500mm	30-40507200	\$1,310.00
S4 600mm	30-40607200	\$1,504.00
S4 750mm	30-40757200	\$1,930.00
S4 900mm	30-40907200	\$2,350.00

6mm Flight Thickness, 1.2m Overall Length, optional specifications incl. hub options available on request.

65mm Round - Rotating Rock Teeth, Sidewear Tungsten Tiles & Rotating Rock Pilot

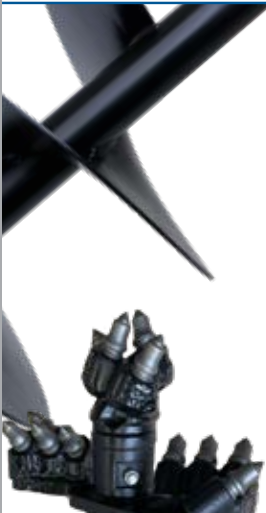

Auger Size	Part Number	RRP
S4 150mm	TBA	\$994.00
S4 200mm	TBA	\$1,128.00
S4 225mm	TBA	\$1,173.00
S4 250mm	TBA	\$1,234.00
S4 300mm	TBA	\$1,280.00
S4 350mm	TBA	\$1,383.00
S4 400mm	TBA	\$1,501.00
S4 450mm	TBA	\$1,597.00
S4 500mm	TBA	\$1,701.00
S4 600mm	TBA	\$1,896.00
S4 750mm	TBA	\$2,342.00
S4 900mm	TBA	\$2,762.00

6mm Flight Thickness, 1.2m Overall Length, optional specifications incl. hub options available on request.

S4 WEAR PARTS

Description	Part Number	RRP
TOOTH - S4 SHOCK LOCK FLAT TUNGSTEN (A)	33-9124-KIT	\$38.00
TOOTH - S4 SHOCK LOCK FLAT TUNGSTEN CHISEL (B)	33-9123-KIT	\$27.00
PILOT - S4 FLAT TUNGSTEN (C)	33-9222-KIT	\$87.00
TOOTH - S4 SHOCK LOCK TUNGSTEN (D)	33-9122-KIT	\$47.00
TOOTH - S4 SHOCK LOCK TUNGSTEN CHISEL (E)	33-9125-KIT	\$27.00
PILOT - S4 TUNGSTEN (F)	33-9204-KIT	\$144.00
PILOT - S4 EXTRA DIG (G)	33-9212-KIT	\$171.00
TOOTH - S5 / S6 ROCK (H)	33-9107	\$36.00
PILOT - S5 / S6 ROCK (I)	33-9207-KIT	\$161.00
POCKET - S4 SHOCK LOCK	33-1010	\$26.00
POCKET - S5 / S6 ROCK	33-1013	\$24.00
DRIVE LUG - UP TO 250mm (42mm dia)	33-4105	\$39.00
DRIVE LUG - 300mm & ABOVE (60mm dia)	33-4102	\$38.00
PIN & CLIP - S4 65mm RND	30-0004-KIT	\$31.00
PIN & CLIP - S4 2" HEX	30-0003-KIT	\$33.00
S4 AUGER PIN CLIP	99-99020	\$6.00
DRIVE LUG - S4 EXTENSION	33-4106-KIT	\$77.00
TOOTH - ROTATING HARD ROCK TOOTH	33-9129	\$20.00
POCKET - ROTATING HARD ROCK TOOTH HOLDER	33-4121	\$26.00
PILOT KIT - ROTATING HARD ROCK TOOTH PILOT	33-9256-KIT	\$298.00

All Shock Lock™ teeth come with rubber & pin, all pilots come with nut & bolt.



C



F



G



I



H



A

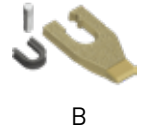

B

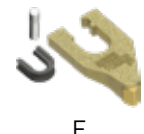

E

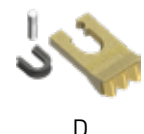

D

65mm Round Extensions

Extension Length	Part Number	RRP
S4 500mm	31-4050200	\$250.00
S4 800mm	31-4080200	\$289.00
S4 1000mm	31-4100200	\$306.00
S4 1200mm	31-4120200	\$343.00
S4 1000mm Telescopic Complete Unit	31-410TJ00	\$430.00
S4 1500mm Telescopic Complete Unit	31-415TJ00	\$495.00

Auger Pin & clip supplied in male end

S4 65mm Round
Fixed Extension



S4 65mm Round
Telescopic Extension

S4 CLEAN OUT DISCS

65mm Round Clean Out Discs

Diameter	Part Number	RRP
S4 300mm	36-40300201	\$623.00
S4 350mm	36-40350201	\$718.00
S4 450mm	36-40450201	\$864.00
S4 600mm	36-40600201	\$1,107.00



S5 RANGE EARTH DRILLS

75mm Square

Earth Drill 8000 MAX



Description

Earth Drill 5500 MAX

Earth Drill 5500 TC (Truck Crane only)

Earth Drill 7000 MAX

Earth Drill 7000 TC (Truck Crane only)

Earth Drill 8000 MAX

Part Number

21-34306F1200S2001

21-3470001100S2601

21-35422F1200S2001

21-3480001100S2001

21-35522F1200S2001

RRP

\$3,986.00

\$4,499.00

\$4,926.00

\$4,926.00

\$5,057.00

For flow & pressure information on each drive please refer to the table on page 4.

All Earth Drills except TC models include Flat Face Couplers and Hydraulic hoses.
Advise requirements at time of purchase.

S5 RANGE FRAMES

To suit Earth Drill 5000 to 8000MAX

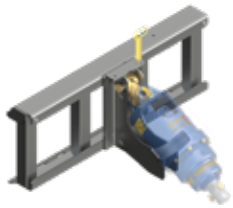

Universal Center Mount
Earth Drill frame to
Suit Skidsteer Loader

Description

UNIVERSAL Skid Steer Slide Mount Earth Drill Frame

JCB Q-FIT Telehandler Slide Mount Earth Drill Frame

MANITOU Telehandler Slide Mount Earth Drill Frame

MERLO ZM2 Telehandler Slide Mount Earth Drill Frame

MERLO ZM3 Telehandler Slide Mount Earth Drill Frame

Part Number

19-9033-244

19-9057-244

19-9076-244

19-9077-244

19-9078-244

RRP

\$999.00

\$1,461.00

\$1,548.00

\$1,461.00

\$1,461.00



DOUBLE PIN HITCHES

To suit Earth Drill 5000-8000MAX

Pin Diameter	Part Number	RRP
40mm PIN	12-304035	\$881.00
1 3/4" PIN	12-304435	\$900.00
45mm PIN	12-304535	\$900.00
50mm PIN	12-305035	\$984.00
55mm PIN	12-305535	\$1,084.00
60mm PIN	12-306035	\$1,155.00
65mm PIN	12-306535	\$1,248.00



Double Pin Hitch

DOUBLE PIN CRADLE HITCHES

To suit Earth Drill 5000-8000MAX

Pin Diameter	Part Number	RRP
40mm PIN	13-304035	\$1,222.00
1 3/4" PIN	13-304435	\$1,252.00
45mm PIN	13-304535	\$1,252.00
50mm PIN	13-305035	\$1,336.00
55mm PIN	13-305535	\$1,436.00
60mm PIN	13-306035	\$1,507.00
65mm PIN	13-306535	\$1,604.00



Double Pin Cradle Hitch



S5 RANGE AUGERS

75mm Square - Tungsten Teeth & Tungsten Pilot



Auger Size	Part Number	RRP
S5 150mm	30-50155600	\$846.00
S5 200mm	30-50205600	\$926.00
S5 225mm	30-50235600	\$967.00
S5 250mm	30-50255600	\$1,037.00
S5 300mm	30-50305600	\$1,092.00
S5 350mm	30-50355600	\$1,187.00
S5 400mm	30-50405600	\$1,282.00
S5 450mm	30-50455600	\$1,414.00
S5 500mm	30-50505600	\$1,490.00
S5 600mm	30-50605600	\$1,782.00
S5 750mm	30-50755600	\$2,073.00
S5 900mm	30-50905600	\$2,767.00
S5 1000mm	30-51005600	\$2,939.00
S5 1200mm	30-51205600	\$4,502.00

8mm Flight Thickness, 1.57m Overall Length, optional specifications incl. hub options available on request.

75mm Square - Rock Teeth & Rock Pilot

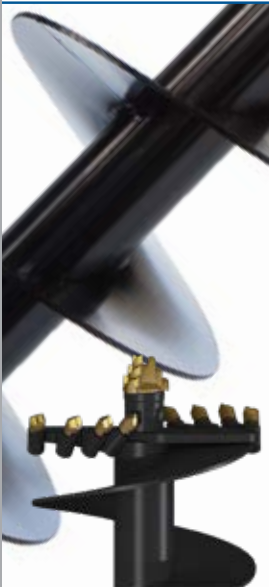

Auger Size	Part Number	RRP
S5 150mm	30-50156600	\$948.00
S5 200mm	30-50206600	\$1,043.00
S5 225mm	30-50236600	\$1,136.00
S5 250mm	30-50256600	\$1,208.00
S5 300mm	30-50306600	\$1,231.00
S5 350mm	30-50356600	\$1,384.00
S5 400mm	30-50406600	\$1,448.00
S5 450mm	30-50456600	\$1,557.00
S5 500mm	30-50506600	\$1,681.00
S5 600mm	30-50606600	\$1,962.00
S5 750mm	30-50756600	\$2,493.00
S5 900mm	30-50906600	\$2,869.00
S5 1000mm	30-51006600	\$3,310.00
S5 1200mm	30-51206600	\$4,729.00

8mm Flight Thickness, 1.57m Overall Length, optional specifications incl. hub options available on request.

75mm Square - Rotating Rock Teeth, Sidewear Tungsten Tiles & Rotating Rock Pilot



Auger Size	Part Number	RRP
S5 150mm	TBA	\$1,257.00
S5 200mm	TBA	\$1,352.00
S5 225mm	TBA	\$1,445.00
S5 250mm	TBA	\$1,517.00
S5 300mm	TBA	\$1,540.00
S5 350mm	TBA	\$1,693.00
S5 400mm	TBA	\$1,839.00
S5 450mm	TBA	\$1,948.00
S5 500mm	TBA	\$2,072.00
S5 600mm	TBA	\$2,352.00
S5 750mm	TBA	\$2,905.00
S5 900mm	TBA	\$3,280.00
S5 1000mm	TBA	\$3,773.00
S5 1200mm	TBA	\$5,193.00

8mm Flight Thickness, 1.57m Overall Length, optional specifications incl. hub options available on request.

S5 EXTENSIONS

75mm Square - Extensions

Extension Length	Part Number	RRP
S5 1000mm	31-5100600	\$533.00
S5 1500mm	31-5150600	\$618.00
S5 2000mm	31-5200600	\$697.00
S5 2500mm	31-5250600	\$773.00
S6 1500mm Telescopic Extension (15,000Nm max)	31-6150T600	\$738.00
S6 2000mm Telescopic Extension (15,000Nm max)	31-6200T600	\$894.00

Auger Pin & clip supplied in male end

S5 75mm Square
Fixed Extension



S6 75mm Square
Telescopic Extension

S5/S6 CLEAN OUT DISCS

75mm Square - Clean Out Discs

Disc Diameter	Part Number	RRP
S5/S6 300mm	36-60300601	\$662.00
S5/S6 350mm	36-60350601	\$752.00
S5/S6 450mm	36-60450601	\$900.00
S5/S6 600mm	36-60600601	\$1,183.00



S5 WEAR PARTS

Description	Part Number	RRP
TOOTH - S5 / S6 SHOCK LOCK TUNGSTEN (B)	33-9127-KIT	\$49.00
PILOT - S5 / S6 TUNGSTEN (A)	33-9206-KIT	\$182.00
TOOTH - S5 / S6 ROCK (D)	33-9107	\$36.00
PILOT - S5 / S6 ROCK (C)	33-9207-KIT	\$161.00
POCKET - S5 / S6 SHOCK LOCK	33-1011	\$28.00
POCKET - S5 / S6 ROCK POCKET	33-1013	\$24.00
DRIVE LUG - S5 / S6 1 3/4" HEX	33-4103	\$67.00
PIN & CLIP S5 / S6 AUGER PIN	30-0002-KIT	\$33.00
TOOTH - ROTATING HARD ROCK TOOTH	33-9129	\$20.00
POCKET - ROTATING HARD ROCK TOOTH HOLDER	33-4121	\$26.00
PILOT KIT - ROTATING HARD ROCK TOOTH PILOT	33-9256-KIT	\$298.00

All Shock Lock™ teeth come with rubber & pin, all pilots come with nut & bolt.

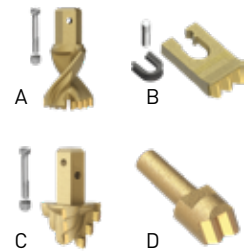

S6 RANGE EARTH DRILLS

75mm Square

Earth Drill 25000MAX



Description	Part Number	RRP
Earth Drill 10000	21-40122F1200S2601	\$5,844.00
Earth Drill 12000 MAX	21-4074101300S2601	\$6,160.00
Earth Drill 15000 MAX	21-4044101300S2601	\$6,546.00
Earth Drill 20000 MAX	21-4534101300S2601	\$9,440.00
Earth Drill 25000 MAX	21-4544106500S2601	\$11,951.00
Case Drain Connection	99-7933	\$341.00

For flow & pressure information on each drive please refer to the table on page 4.

Earth Drills include Flat Face Couplers and Hydraulic hoses. MAX Models include Hydraulic hoses only. Advise requirements at time of purchase.

Case drain fitment & completion of pre-installation checks are required for warranty purposes - please check your manual or with your Auger Torque Dealer.

DOUBLE PIN HITCHES

To suit Earth Drill 10000 to 25000 MAX



Double Pin Hitch

Pin Diameter	Part Number	RRP
1 3/4" PIN	12-454445	\$1,223.00
45mm PIN	12-454545	\$1,223.00
50mm PIN	12-455045	\$1,282.00
55mm PIN	12-455545	\$1,326.00
60mm PIN	12-456045	\$1,366.00
65mm PIN	12-456545	\$1,452.00
70mm PIN	12-457045	\$1,561.00
80mm PIN	12-458045	\$1,744.00



DOUBLE PIN CRADLE HITCHES

To suit Earth Drill 10000 & 15000MAX

Pin Diameter	Part Number	RRP
1 3/4" PIN	13-454440	\$1,671.00
45mm PIN	13-454540	\$1,671.00
50mm PIN	13-455040	\$1,712.00
55mm PIN	13-455540	\$1,769.00
60mm PIN	13-456040	\$1,863.00
65mm PIN	13-456540	\$1,946.00
70mm PIN	13-457040	\$2,057.00
80mm PIN	13-458040	\$2,237.00



Double Pin Cradle Hitch

To suit Earth Drill 20000MAX & 25000MAX

Pin Diameter	Part Number	RRP
1 3/4" PIN	13-454445	\$1,741.00
45mm PIN	13-454545	\$1,741.00
50mm PIN	13-455045	\$1,771.00
55mm PIN	13-455545	\$1,837.00
60mm PIN	13-456045	\$1,932.00
65mm PIN	13-456545	\$2,017.00
70mm PIN	13-457045	\$2,123.00
80mm PIN	13-458045	\$2,309.00



Double Pin Cradle Hitch



S6 AUGERS

75mm Square - Tungsten Teeth & Tungsten Pilot



Auger Size	Part Number	RRP
S6 150mm	30-60155600	\$1,094.00
S6 200mm	30-60205600	\$1,289.00
S6 225mm	30-60235600	\$1,395.00
S6 250mm	30-60255600	\$1,470.00
S6 300mm	30-60305600	\$1,568.00
S6 350mm	30-60355600	\$1,627.00
S6 400mm	30-60405600	\$1,718.00
S6 450mm	30-60455600	\$1,832.00
S6 500mm	30-60505600	\$2,005.00
S6 600mm	30-60605600	\$2,242.00
S6 750mm	30-60755600	\$2,646.00
S6 900mm	30-60905600	\$3,389.00
S6 1000mm	30-61005600	\$3,825.00
S6 1200mm	30-61205600	\$5,068.00
S6 1500mm	30-61505600	\$7,214.00

12mm Flight Thickness, 1.87m Overall Length, optional specifications incl. hub options available on request.

75mm Square - Rock Teeth & Rock Pilot



Auger Size	Part Number	RRP
S6 150mm	30-60156600	\$1,257.00
S6 200mm	30-60206600	\$1,351.00
S6 225mm	30-60236600	\$1,508.00
S6 250mm	30-60256600	\$1,595.00
S6 300mm	30-60306600	\$1,696.00
S6 350mm	30-60356600	\$1,891.00
S6 400mm	30-60406600	\$2,058.00
S6 450mm	30-60456600	\$2,249.00
S6 500mm	30-60506600	\$2,504.00
S6 600mm	30-60606600	\$2,824.00
S6 750mm	30-60756600	\$3,486.00
S6 900mm	30-60906600	\$4,101.00
S6 1000mm	30-61006600	\$4,896.00
S6 1200mm	30-61206600	\$6,301.00
S6 1500mm	30-61506600	\$8,250.00

12mm Flight Thickness, 1.87m Overall Length, optional specifications incl. hub options available on request.

75mm Square - Hard Rock Auger - Rotating Rock Teeth, Rock Pilot



Diameter	Part Number	RRP
S6 300mm Hard Rock Auger	30-70307600T	\$3,390.00
S6 450mm Hard Rock Auger	30-70457600T	\$4,499.00
S6 600mm Hard Rock Auger	30-70607600T	\$5,660.00
S6 750mm Hard Rock Auger	30-70757600T	\$6,841.00

20mm & 12mm Flight Thickness, 2.3m Overall Length, optional specifications incl. hub options available on request.

S6 EXTENSIONS

75mm Square - Extensions

Extension Length	Part Number	RRP
S6 1000mm	31-6100600	\$700.00
S6 1500mm	31-6150600	\$794.00
S6 2000mm	31-6200600	\$914.00
S6 2500mm	31-6250600	\$987.00
S6 3000mm	31-6300600	\$1,091.00
S6 1500mm Telescopic Complete (15,000Nm max)	31-6150T600	\$738.00
S6 2000mm Telescopic Complete (15,000Nm max)	31-6200T600	\$894.00

S6 75mm Square
Fixed Extension



S6 75mm Square
Telescopic Extension

Auger Pin & clip supplied in male end

S5/S6 CLEAN OUT DISCS

75mm Square - Clean Out Discs

Disc Diameter	Part Number	RRP
S5/S6 300mm	36-60300601	\$662.00
S5/S6 350mm	36-60350601	\$752.00
S5/S6 450mm	36-60450601	\$900.00
S5/S6 600mm	36-60600601	\$1,183.00



S6 WEAR PARTS

Description	Part Number	RRP
TOOTH - S5 / S6 SHOCK LOCK TUNGSTEN (B)	33-9127-KIT	\$47.00
PILOT - S5 / S6 TUNGSTEN (A)	33-9206-KIT	\$182.00
TOOTH - S5 / S6 ROCK (D)	33-9107	\$36.00
PILOT - S5 / S6 ROCK (C)	33-9207-KIT	\$161.00
POCKET - S5 / S6 SHOCK LOCK	33-1011	\$28.00
POCKET - S5 / S6 ROCK POCKET	33-1013	\$24.00
DRIVE LUG - S5 / S6 1 3/4" HEX	33-4103	\$67.00
PIN & CLIP S5 / S6 AUGER PIN	30-0002-KIT	\$33.00
TOOTH - ROTATING HARD ROCK TOOTH	33-9129	\$20.00
POCKET - ROTATING HARD ROCK TOOTH HOLDER	33-4121	\$26.00
PILOT KIT - ROTATING HARD ROCK TOOTH PILOT	33-9256-KIT	\$298.00

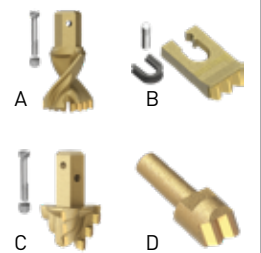

All Shock Lock™ teeth come with rubber & pin, all pilots come with nut & bolt.

PA RANGE EARTH DRILL

110mm Square

Earth Drill 42000MAX



Description	Part Number	RRP
EARTH DRILL 35,000 MAX	21-5064100600S3101	\$20,740.00
EARTH DRILL 42,000 MAX	21-5074100600S3101	\$21,855.00
EARTH DRILL 65,000 MAX	21-5080003100S3101	\$30,834.00
Case Drain Connection	99-7933	\$341.00

For flow & pressure information on each drive please refer to the table on page 4.

Earth Drill 35,000MAX & 42,000MAX include 1" x 2.2M long hoses. Hoses are not supplied with larger drives. Advise requirements at time of purchase.

Case drain fitment & completion of pre-installation checks are required for warranty purposes - please check your manual or with your Auger Torque Dealer.

DOUBLE PIN CRADLE HITCHES

To suit Earth Drill 35000MAX to 65000 MAX



Double Pin Cradle Hitch

Pin Diameter	Part Number	RRP
55mm PIN	13-605550	\$3,357.00
60mm PIN	13-606050	\$3,357.00
65mm PIN	13-606550	\$3,496.00
70mm PIN	13-607050	\$3,496.00
80mm PIN	13-608050	\$3,632.00
90mm PIN	13-609050	\$3,769.00
100mm PIN	13-610050	\$3,905.00
110mm PIN	13-611050	\$4,043.00

PA AUGERS

110mm Square - Rock Teeth & Rock Pilot



Auger Size	Part Number	RRP
PA 300mm	30-70306700	\$3,160.00
PA 350mm	30-70356700	\$3,413.00
PA 400mm	30-70406700	\$3,683.00
PA 450mm	30-70456700	\$3,751.00
PA 500mm	30-70506700	\$3,953.00
PA 600mm	30-70606700	\$4,489.00
PA 700mm	30-70706700	\$4,872.00
PA 750mm	30-70756700	\$5,095.00
PA 800mm	30-70806700	\$5,551.00
PA 900mm	30-70906700	\$5,846.00
PA 1000mm	30-71006700	\$7,068.00
PA 1200mm	30-71206700	\$9,165.00
PA 1500mm	30-71506700	\$12,365.00
PA 1800mm	30-71806700	POA
PA 2000mm	30-72006700	POA
PA 2400mm	30-72406700	POA

20mm & 12mm Flight Thickness, 2.3m Overall Length, optional specifications incl. hub options available on request.

PA HARD ROCK AUGER

110mm Square - Hard Rock Auger - Rotating Rock Teeth, Rock Pilot

Diameter	Part Number	RRP
PA 300mm Hard Rock Auger	30-70307700T	\$3,884.00
PA 450mm Hard Rock Auger	30-70457700T	\$4,939.00
PA 600mm Hard Rock Auger	30-70607700T	\$6,045.00
PA 750mm Hard Rock Auger	30-70757700T	\$7,168.00

20mm & 12mm Flight Thickness, 2.3m Overall Length, optional specifications incl. hub options available on request.

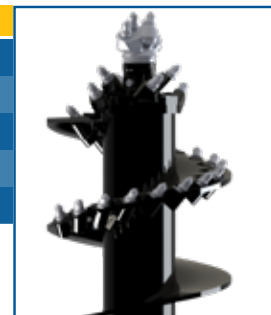

PA EXTENSIONS

110mm Square

Extension Length	Part Number	RRP
PA 2m	31-7200700	\$3,047.00
PA 3m	31-7300700	\$3,281.00
PA 4m	31-7400700	\$3,516.00
PA 5m	31-7500700	\$3,749.00
PA 6m	31-7600700	\$3,980.00
PA 2m TELESCOPIC	31-7200T70	\$3,229.00
PA 3m TELESCOPIC	31-7300T70	\$3,637.00

Auger Pin & clip supplied in male end

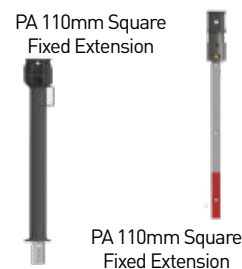

PA CLEAN OUT DISCS

110mm Square Clean Out Discs

Disc Diameter	Part Number	RRP
PA 300mm	36-70300701	\$989.00
PA 350mm	36-70350701	\$1,055.00
PA 450mm	36-70450701	\$1,192.00
PA 600mm	36-70600701	\$1,552.00
PA 750mm	36-70750701	\$1,842.00
PA 900mm	36-70900701	\$2,313.00



PA WEAR PARTS

Description	Part Number	RRP
TOOTH - PA - ROCK (B)	33-9109	\$115.00
PILOT - PA - ROCK (A)	33-9209-KIT	\$472.00
PILOT - PA ROCK - CENTRE (C1)	33-9209-1	\$224.00
PILOT - PA - ROCK - SMALL FLANGE (C2)	33-9209-2	\$120.00
PILOT - PA - ROCK - LARGE FLANGE (C3)	33-9209-3	\$166.00
TOOTH HOLDER - PA WITH LOCATOR (D)	33-1012	\$50.00
PILOT DRIVE - PA - 2" HEX	33-4104	\$123.00
PIN & CLIP - PA 110mm SQUARE	23-3900-KIT	\$70.00
TOOTH - ROTATING HARD ROCK TOOTH	33-9129	\$20.00
POCKET - ROTATING HARD ROCK TOOTH HOLDER	33-4121	\$26.00
PILOT KIT - ROTATING HARD ROCK TOOTH PILOT	33-9256-KIT	\$298.00

All pilots come with nut & bolt.

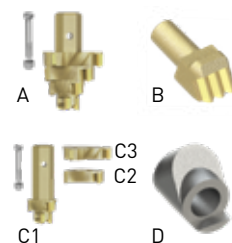

SCREWPILE RANGE EARTH DRILL

Earth Drill 150000MAX



Description	Part Number	RRP
EARTH DRILL 80,000 MAX 130 HEX	21-50850	\$42,500.00
EARTH DRILL 100,000 MAX 150 HEX	21-55100	\$50,784.00
EARTH DRILL 150,000 MAX 150 HEX	21-55150	\$56,517.00
Case Drain Connection	99-7933	\$341.00

For flow & pressure information on each drive please refer to the table on page 4.

Hoses are not supplied with screwpile range drives. Advise requirements at time of purchase.

Case drain fitment & completion of pre-installation checks are required for warranty purposes - please check your manual or with your Auger Torque Dealer.

HITCHES, HUBS & ACCESSORIES

To suit Earth Drill 80,000MAX, 100,000MAX & 150,000MAX



Drive Cradle Section

Pin Diameter	Part Number	RRP
Drive Cradle section 80MAX (Pins & Ears POA)	13-6913	\$4,050.00
Drive Cradle section 100MAX (Pins & Ears POA)	13-6911	\$4,330.00
Drive Cradle section 150MAX (Pins & Ears POA)	13-6912	\$4,590.00
Linkage Block	11-0017	\$957.00
80mm Hood Pin	23-5518	\$186.00
130mm Hex Hub Female	35-7093	\$1,068.00
130mm Hex Hub Pin - 30 mm Dia	30-0014-KIT	\$67.00
130mm Hex Hub Pin Clip	99-99020	\$6.00
150mm Hex Hub Female	35-7110	\$1,082.00
150mm Hex Hub Pin - 40mm Dia	30-0015	\$89.00
150mm Hex Hub Pin Clip	99-99022	\$6.00
Case Drain Connection	99-7933	\$324.00
Shaft Adaptor - 130HEX to 130SQ	31-7922	\$1,810.00
Shaft Adaptor - 150HEX to 130SQ	35-7110-130S-FAB	\$1,899.00
PA 130mm Sq Hub Male	35-7110-130S	\$936.00





MT600 TRENCHER

600mm Trenching Depth

	Description	Part Number	RRP
	MT600 TRENCHER Direct Drive	41-D60060110007001	\$4,373.00
	MT600 TRENCHER suit Skid Steer Loaders	45-06S060110003001	\$4,696.00
	MT600 TRENCHER suit Excavators/Mini Loaders	45-06E060110003001	\$4,696.00
All MT Trenchers include Flat Face Couplers and Hydraulic hoses.*			
<p>Please select the frame / hitch and chain suited to your machine and application.</p>			

Universal Frames to suit MT Range

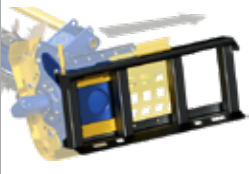
	Description	Part Number	RRP
	UNIVERSAL SKID STEER FRAME	19-9012	\$477.00
	UNIVERSAL MINI LOADER FRAME	16-9002-N-FAB	\$483.00
See page 32 for Non-Universal Pick Up Frames			

Hitches to suit MT Trencher Range

	Pin Diameter	Part Number	RRP
	30mm PIN	15-53000	\$707.00
	35mm PIN	15-53500	\$770.00
	38mm PIN	15-53800	\$824.00
	40mm PIN	15-54000	\$853.00
	45mm PIN	15-54500	\$948.00
	50mm PIN	15-55000	\$1,005.00

600mm Trenching Depth Chains to suit MT600

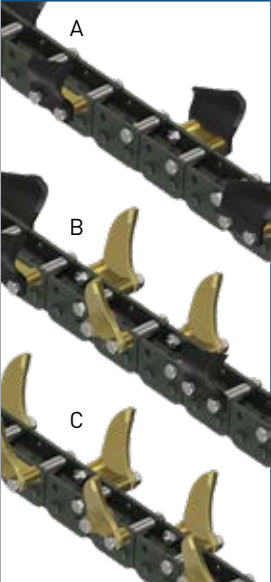
	Chain Width - Type	Part Number	RRP
	100mm x 600mm - Earth (A)	44-2901	\$466.00
	100mm x 600mm - Combination (B)	44-2902	\$662.00
	100mm x 600mm - Tungsten (C)	44-2918	\$712.00
	150mm x 600mm - Earth	44-2903	\$503.00
	150mm x 600mm - Combination	44-2904	\$757.00
	150mm x 600mm - Tungsten	44-2913	\$797.00
	200mm x 600mm - Earth	44-2905	\$550.00
	200mm x 600mm - Combination	44-2906	\$802.00
	200mm x 600mm - Tungsten	44-2914	\$838.00
	250mm x 600mm - Earth	44-2940	\$610.00
	250mm x 600mm - Combination	44-2919	\$918.00
	250mm x 600mm - Tungsten	44-2945	\$937.00
	300mm x 600mm - Earth	44-2936	\$663.00
	300mm x 600mm - Combination	44-2937	\$925.00
300mm x 600mm - Tungsten	44-2938	\$980.00	

*Where hoses & couplers are supplied, they are to Auger Torque standard specification. Other specifications available on request.

MT900 TRENCHER

900mm Trenching Depth

Description	Part Number	RRP
MT900 TRENCHER Direct Drive	41-D90060110009001	\$4,453.00
MT900 TRENCHER suit Skid Steer Loaders	45-09S060110003001	\$4,774.00
MT900 TRENCHER suit Excavators/Mini Loaders	45-09E060110003001	\$4,774.00

All MT Trenchers include Flat Face Couplers and Hydraulic hoses.*

Please select the frame / hitch and chain suited to your machine and application.

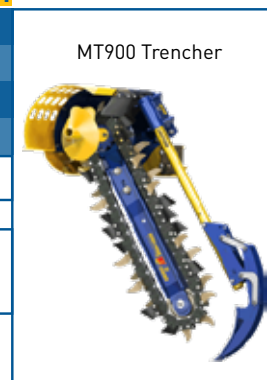

MT900 Trencher

Universal Frames to suit MT Range

Description	Part Number	RRP
UNIVERSAL SKID STEER FRAME	19-9012	\$477.00
UNIVERSAL MINI LOADER FRAME	16-9002-N-FAB	\$483.00

See page 32 for Non-Universal Pick Up Frames

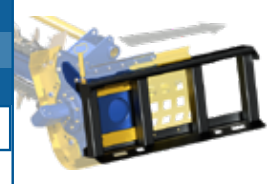

Hitches to suit MT Trencher Range

Pin Diameter	Part Number	RRP
30mm PIN	15-53000	\$707.00
35mm PIN	15-53500	\$770.00
38mm PIN	15-53800	\$824.00
40mm PIN	15-54000	\$853.00
45mm PIN	15-54500	\$948.00
50mm PIN	15-55000	\$1,005.00

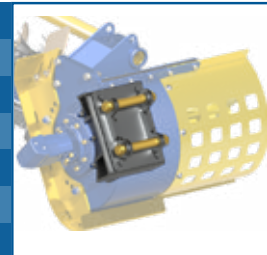

900mm Trenching Depth Chains to suit MT900

Chain Width - Type	Part Number	RRP
100mm x 900mm - Earth (A)	44-2907	\$624.00
100mm x 900mm - Combination (B)	44-2908	\$901.00
100mm x 900mm - Tungsten (C)	44-2916	\$950.00
150mm x 900mm - Earth	44-2909	\$670.00
150mm x 900mm - Combination	44-2910	\$985.00
150mm x 900mm - Tungsten	44-2920	\$1,010.00
200mm x 900mm - Earth	44-2911	\$713.00
200mm x 900mm - Combination	44-2912	\$1,041.00
200mm x 900mm - Tungsten	44-2921	\$1,080.00
250mm x 900mm - Earth	44-2939	\$770.00
250mm x 900mm - Combination	44-2915	\$1,225.00
250mm x 900mm - Tungsten	44-2941	\$1,303.00
300mm x 900mm - Earth	44-2933	\$1,315.00
300mm x 900mm - Combination	44-2934	\$1,458.00
300mm x 900mm - Tungsten	44-2935	\$1,484.00

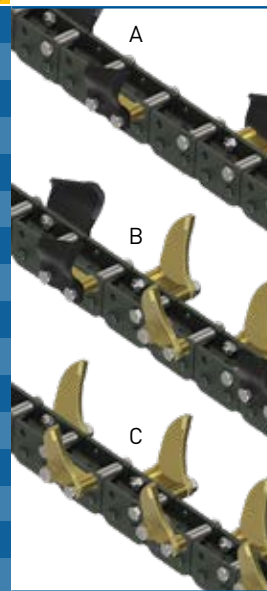

*Where hoses & couplers are supplied, they are to Auger Torque standard specification. Other specifications available on request.

MT1200 TRENCHER

1200mm Trenching Depth



Description	Part Number	RRP
MT1200 TRENCHER suit Skid Steer Loaders	45-12S060110003001	\$4,856.00
MT1200 TRENCHER suit Excavators/Mini Loaders	45-12E060110003001	\$4,856.00

All MT Trenchers include Flat Face Couplers and Hydraulic hoses.*

Please select the frame / hitch and chain suited to your machine and application.

*Where hoses & couplers are supplied, they are to Auger Torque standard specification. Other specifications available on request.

Universal Frames to suit MT Range

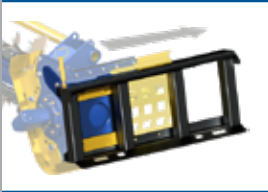

Description	Part Number	RRP
UNIVERSAL SKID STEER FRAME	19-9012	\$477.00
UNIVERSAL MINI LOADER FRAME-N-FAB	16-9002	\$483.00

See page 32 for Non-Universal Pick Up Frames

Hitches to suit MT Trencher Range

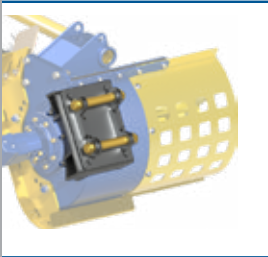

Pin Diameter	Part Number	RRP
38mm PIN	15-53800	\$824.00
40mm PIN	15-54000	\$853.00
45mm PIN	15-54500	\$948.00
50mm PIN	15-55000	\$1,005.00

1200mm Trenching Depth Chains to suit MT1200

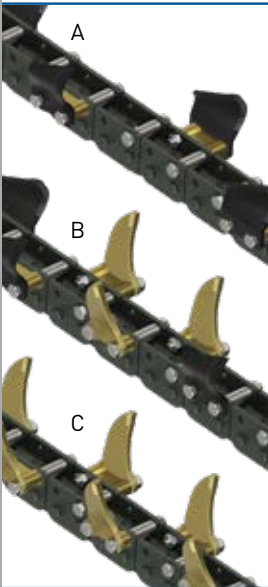

Chain Width - Type	Part Number	RRP
100mm x 1200mm - Earth (A)	44-2924	\$800.00
100mm x 1200mm - Combination (B)	44-2925	\$1,149.00
100mm x 1200mm- Tungsten (C)	44-2926	\$1,239.00
150mm x 1200mm - Earth	44-2923	\$856.00
150mm x 1200mm - Combination	44-2922	\$1,223.00
150mm x 1200mm - Tungsten	44-2917	\$1,292.00
200mm x 1200mm - Earth	44-2927	\$920.00
200mm x 1200mm - Combination	44-2928	\$1,307.00
200mm x 1200mm - Tungsten	44-2929	\$1,372.00

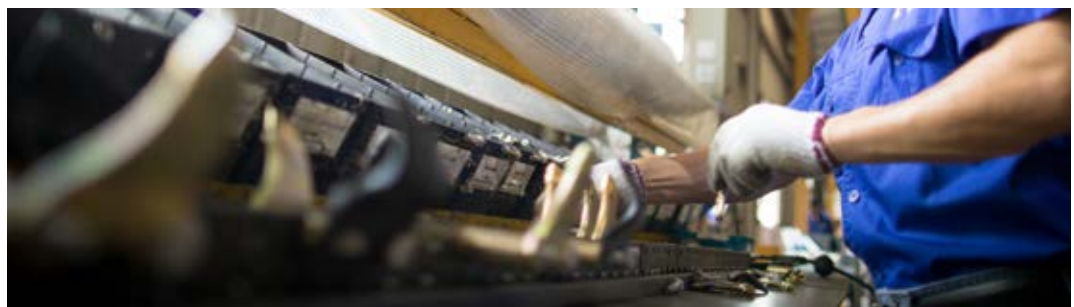

XHD900 TRENCHER

900mm Trenching Depth

Description	Part Number	RRP
XHD900 TRENCHER 4K	43-09S220040005001	\$7,500.00

All XHD Trenchers include Flat Face Couplers and Hydraulic hoses.*

Please select the frame / hitch and chain suited to your machine and application.

XHD900 Trencher

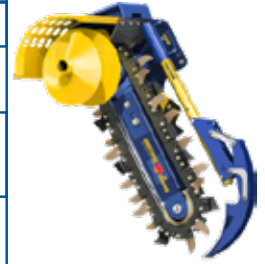

*Where hoses & couplers are supplied, they are to Auger Torque standard specification. Other specifications available on request.

Skidsteer Loader Frame to suit XHD Range

Description	Part Number	RRP
UNIVERSAL SIDE SHIFT HEAVY DUTY	19-9020	\$755.00



Hitches to suit XHD Trencher Range

Pin Diameter	Part Number	RRP
40mm PIN	15-64000	\$1,096.00
1 3/4" PIN	15-64400	\$1,120.00
45mm PIN	15-64500	\$1,120.00
50mm PIN	15-65000	\$1,175.00
55mm PIN	15-65500	\$1,220.00
60mm PIN	15-66000	\$1,260.00
65mm PIN	15-66500	\$1,284.00

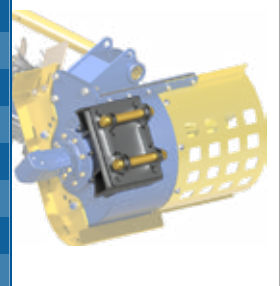

900mm Trenching Depth Chains to suit XHD900

Chain Width - Type	Part Number	RRP
150mm x 900mm - Earth (A)	44-3904	\$1,001.00
150mm x 900mm - Combination (B)	44-3905	\$1,266.00
150mm x 900mm - Tungsten (C)	44-3906	\$1,285.00
200mm x 900mm - Earth	44-3907	\$1,050.00
200mm x 900mm - Combination	44-3908	\$1,364.00
200mm x 900mm - Tungsten	44-3909	\$1,395.00
250mm x 900mm - Earth	44-3910	\$1,156.00
250mm x 900mm - Combination	44-3911	\$1,508.00
250mm x 900mm - Tungsten	44-3912	\$1,554.00
300mm x 900mm - Earth	44-3913	\$1,421.00
300mm x 900mm - Combination	44-3914	\$1,896.00
300mm x 900mm - Tungsten	44-3915	\$1,941.00
350mm x 900mm - Earth	44-3916	\$1,590.00
350mm x 900mm - Combination	44-3917	\$1,990.00
350mm x 900mm - Tungsten	44-3918	\$2,040.00

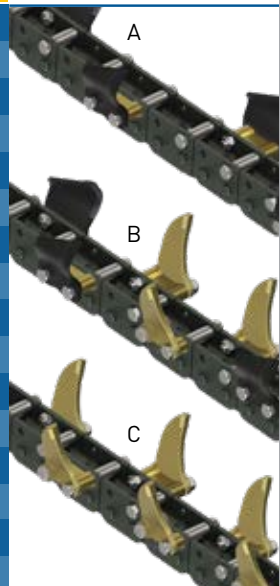

XHD1200 TRENCHER

1200mm Trenching Depth

XHD1200 Trencher	Description	Part Number	RRP
	XHD1200 TRENCHER 4K	43-12S220040005001	\$7,700.00
All XHD Trenchers include Flat Face Couplers and Hydraulic hoses.*			
<p>Please select the frame / hitch and chain suited to your machine and application.</p>			
<p>*Where hoses & couplers are supplied, they are to Auger Torque standard specification. Other specifications available on request.</p>			

Skidsteer Loader Frame to suit XHD Range

Description	Part Number	RRP
 UNIVERSAL SIDE SHIFT HEAVY DUTY	19-9020	\$755.00

Hitches to suit XHD Trencher Range

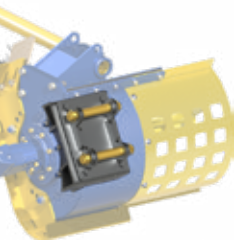
Pin Diameter	Part Number	RRP
 40mm PIN	15-64000	\$1,096.00
1 3/4" PIN	15-64400	\$1,120.00
45mm PIN	15-64500	\$1,120.00
50mm PIN	15-65000	\$1,175.00
55mm PIN	15-65500	\$1,220.00
60mm PIN	15-66000	\$1,260.00
65mm PIN	15-66500	\$1,284.00

1200mm Trenching Depth Chains to suit XHD1200

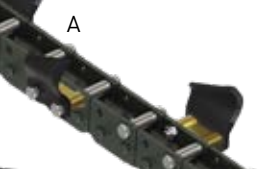
Chain Width - Type	Part Number	RRP
 150mm x 1200mm - Earth (A)	44-3922	\$1,231.00
150mm x 1200mm - Combination (B)	44-3923	\$1,609.00
150mm x 1200mm - Tungsten (C)	44-3924	\$1,666.00
200mm x 1200mm - Earth	44-3925	\$1,264.00
200mm x 1200mm - Combination	44-3926	\$1,639.00
200mm x 1200mm - Tungsten	44-3927	\$1,685.00
250mm x 1200mm - Earth	44-3928	\$1,371.00
250mm x 1200mm - Combination	44-3929	\$1,929.00
250mm x 1200mm - Tungsten	44-3930	\$1,964.00
300mm x 1200mm - Earth	44-3931	\$1,657.00
300mm x 1200mm - Combination	44-3932	\$2,204.00
300mm x 1200mm - Tungsten	44-3933	\$2,253.00

XHD1500 TRENCHER

1500mm Trenching Depth

Description	Part Number	RRP
XHD1500 TRENCHER 4K	43-15S220040005001	\$7,900.00

All XHD Trenchers include Flat Face Couplers and Hydraulic hoses.*

Please select the frame / hitch and chain suited to your machine and application.

*Where hoses & couplers are supplied, they are to Auger Torque standard specification. Other specifications available on request.

XHD1500 Trencher



Skidsteer Loader Frame to suit XHD Range

Description	Part Number	RRP
UNIVERSAL SIDE SHIFT HEAVY DUTY	19-9020	\$755.00



Hitches to suit XHD Trencher Range

Pin Diameter	Part Number	RRP
1 3/4" PIN	15-64400	\$1,120.00
45mm PIN	15-64500	\$1,120.00
50mm PIN	15-65000	\$1,175.00
55mm PIN	15-65500	\$1,220.00
60mm PIN	15-66000	\$1,260.00
65mm PIN	15-66500	\$1,284.00

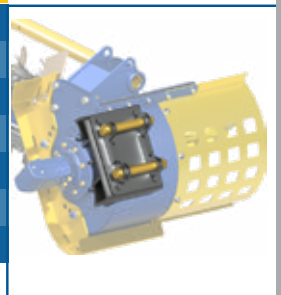

1500mm Trenching Depth Chains to suit XHD1500

Chain Width - Type	Part Number	RRP
150mm x 1500mm - Earth (A)	44-3937	\$1,426.00
150mm x 1500mm - Combination (B)	44-3938	\$1,852.00
150mm x 1500mm - Tungsten (C)	44-3939	\$1,929.00
200mm x 1500mm - Earth	44-3940	\$1,490.00
200mm x 1500mm - Combination	44-3941	\$1,970.00
200mm x 1500mm - Tungsten	44-3942	\$2,035.00

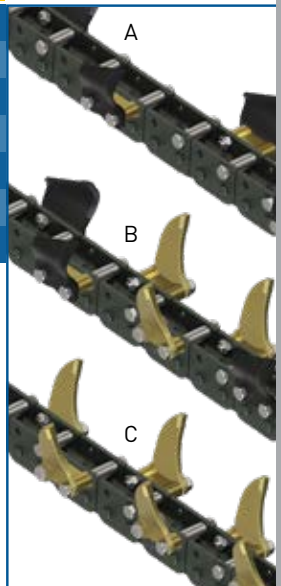

TRENCHER FRAMES & WEAR PARTS

AUGER TORQUE TRENCHERS

Frames to suit MT Range



Description	Part Number	RRP
Mini Loader Trencher Frame	16-9002-N-FAB	\$483.00
Avant / Multi-One Mini Loader Trencher Frame	15-2902	\$699.00
RC30 & PT30 Side Shift Trencher Frame	19-9024	\$817.00
Bobcat 463 / S70 Side Shift Trencher Frame	19-9048	\$817.00
Mustang Single Pin Side Shift Trencher Frame	19-9056	\$892.00
New Holland L555 Side Shift Trencher Frame	19-9060	\$817.00
Toyota 4SDK8/5SDK8 Side Shift Trencher Frame	19-9062	\$817.00
Toyota 4SDK4 Side Shift Trencher Frame	19-9064	\$817.00
Toyota 5SDK5 Side Shift Trencher Frame	19-9066	\$817.00
Toyota 5SDK9 Side Shift Trencher Frame	19-9068	\$817.00
Toyota 5SDK10 Side Shift Trencher Frame	19-9070	\$817.00
Toyota 5SDK11 Side Shift Trencher Frame	19-9072	\$817.00
Euro Pick Up Side Shift Trencher Frame	19-9037	\$595.00
JCB Q-Fit Telehandler Trencher Frame	19-9057	\$961.00
Manitou Telehandler Trencher Frame	19-9076	\$1,470.00
MERLO ZM2 Telehandler Trencher Frame	19-9077	\$982.00
MERLO ZM3 Telehandler Trencher Frame	19-9078	\$982.00
Trencher Adaptor Bracket - Excavator to Skidsteer	15-2904	\$416.00

Custom frames starting from \$1200

Wear Parts to suit MT Trencher Range

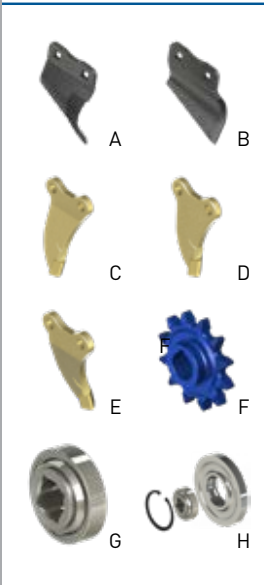

Description	Part Number	RRP
Earth Tooth - Left Hand (A)	44-2010	\$15.00
Earth Tooth - Right Hand (B)	44-2011	\$15.00
Tungsten Tooth - Left Hand (C)	44-2001	\$22.00
Tungsten Tooth - Centre (D)	44-2002	\$22.00
Tungsten Tooth - Right Hand (E)	44-2003	\$22.00
12 Tooth Sprocket (F)	42-1033	\$99.00
Bearing for Nose Roller (G)	99-1207	\$42.00
Circlip for Nose Roller	99-1603	\$11.00
Nose Roller complete with Bearing & Circlip (H)	42-1900	\$137.00
Joining Pin and Locking Pin	44-2022	\$16.00
Boom Adjuster Bolt Kit	42-1902	\$88.00
Trench Cleaner	45-1909	\$753.00
Bare Chain 48 Pitch x 24 Stn (MT600)	44-2026	\$324.00
Bare Chain 64 Pitch x 32 Stn (MT900)	44-2025	\$413.00
Bare Chain 82 Pitch x 41 Stn (MT1200)	44-2024	\$516.00

To suit XHD Trencher Range

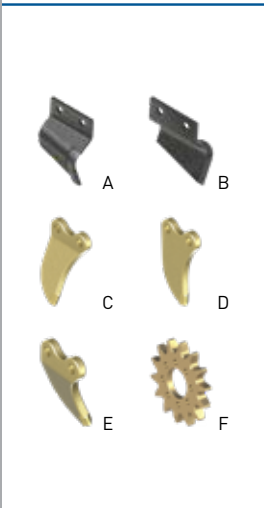

Description	Part Number	RRP
Earth Tooth - Left Hand (A)	44-3001	\$23.00
Earth Tooth - Right Hand (B)	44-3002	\$23.00
Tungsten Tooth - Left Hand (C)	44-3003	\$26.00
Tungsten Tooth - Centre (D)	44-3004	\$26.00
Tungsten Tooth - Right Hand (E)	44-3005	\$26.00
14 Tooth Sprocket (F)	43-1019	\$127.00
Bearing for Nose Roller (G)	99-1213	\$61.00
Circlip for Nose Roller	99-1607	\$11.00
Nose Roller complete with Bearing and Circlip (H)	43-1900	\$256.00
Joining Pin - XHD 2" Pitch Chain	44-3020	\$16.00
Bare Chain 58 Pitch x 29 Stn (XHD900)	44-3017	\$525.00
Bare Chain 72 Pitch x 36 Stn (XHD1200)	44-3013	\$647.00
Bare Chain 86 Pitch x 43 Stn (XHD1500)	44-3015	\$771.00

HEDGE TRIMMERS

Hedge Trimmers & Spare Parts

Description	Part Number	RRP
T150 - 1.5m Hedge Trimmer	51-8903-080-01-	\$5,930.00
1m Hedge Trimmer Cutting Extension	51-8925	\$1,425.00
Hedge Trimmer Blade - Coarse	51-8006-KIT	\$15.00
Hedge Trimmer Finger	51-8013	\$108.00



Hedge Trimmer Excavator Hitches & Skidsteer Frames

Pin Diameter	Part Number	RRP
25mm	51-8091	\$460.00
30mm	51-8092	\$486.00
32mm	51-8090	\$493.00
35mm	51-8093	\$493.00
38mm	51-8098	\$497.00
40mm	51-8094	\$497.00
45mm	51-8095	\$597.00
50mm	51-8096	\$631.00
Hedge Trimmer Angle Mount	51-8922	\$558.00
Hitch Adjuster	51-8912	\$329.00
Frame - Offset Mount Assembly- No Diverter Valve - No SSL	51-8926-00-00	\$1,690.00
Frame - Offset Mount Assembly- With SSL Frame - Diverter	51-8926-01-01	\$4,999.00



MIXER BOWLS

Mixer Bowls

Description	Part Number	RRP
180L MIXER BOWL 65mm ROUND	51-4904-R	\$862.00
180L MIXER BOWL 75mm SQUARE	51-4904-S5	\$925.00



Mixer Bowl Cradle to suit Auger Torque Skidsteer Frames

Description	Part Number	RRP
Mixer Bowl Slide Cradle to suit X1500 to X2500	19-9015-178-SID	\$597.00
Mixer Bowl Slide Cradle to suit 2500 to 4500MAX	19-9015-SID	\$597.00
Mixer Bowl Slide Cradle to suit 5000 to 8000MAX	19-9015-244-SID	\$659.00
Dual Slide Cradle Mixer & Earth Drill suit 2500 to 4500MAX	19-9040	\$1,002.00



Mixer Cradle DPH to suit X1500 to X2500

Pin Diameter	Part Number	RRP
25mm PIN	13-302520M	\$730.00
30mm PIN	13-303020M	\$740.00
32mm PIN	13-303220M	\$899.00
35mm PIN	13-303520M	\$899.00
38mm PIN	13-303820M	\$937.00
40mm PIN	13-304020M	\$937.00



Mixer Cradle DPH to suit 2500 to 4500MAX

Pin Diameter	Part Number	RRP
30mm PIN	13-303030M	\$774.00
32mm PIN	13-303230M	\$935.00
35mm PIN	13-303530M	\$935.00
38mm PIN	13-303830M	\$971.00
40mm PIN	13-304030M	\$971.00
45mm PIN	13-304530M	\$1,104.00

S5 Mixer bowl cradle hitch for excavator use refer to standard Double pin Cradle Hitch on page 15

ALIGNMENT MONITOR



Description	Part Number	RRP
IN-SITE - ALIGNMENT	26-1901	\$2,250.00
IN-SITE - DATA	26-1902	\$3,020.00
IN-SITE - DATA PLUS	26-1903	\$3,980.00

MULCHERS

VM1000 Variable Mulcher



Description	Part Number	RRP
Mulcher - Series 2 - Fixed Tungsten 1m width	69-2900-01-1000	\$21,781.00
Mulcher - Series 2 - Swinging Hammer 1m width	69-2900-02-1000	\$21,297.00
Drum Assembly (Series 2) - 1m - Fixed Tungsten	69-2905-1000	\$3,890.00
Drum Assembly (Series 2) - 1m - Swinging Hammer	69-2905-1000-H	\$3,407.00
Push bar Assembly to suit VM1000	69-2915	\$598.00

VM1500 Variable Mulcher



Description	Part Number	RRP
Mulcher - Series 3 - Fixed Tungsten 1.5m width	69-3905-01-1500	\$38,750.00
Mulcher - Series 3 - Swinging Hammer 1.5m width	69-3905-02-1500	\$37,994.00
Drum Assembly (Series 3) - 1.5m - Fixed Tungsten	69-3910-1500	\$6,052.00
Drum Assembly (Series 3) - 1.5m - Swinging Hammer	69-3910-1500-H	\$4,841.00
Push bar Assembly to suit VM1500	69-3920	\$598.00

VM Mulcher Wear Parts & Hitches



Description	Part Number	RRP
Fixed Tungsten Tooth - Mulcher	69-8201-00	\$62.00
Swinging Hammer Tooth - Mulcher	69-8201-01	\$45.00
VM Double Pin Excavator Hitch 40-45mm Pins	TBA	\$823.00
VM Double Pin Excavator Hitch 50-55mm Pins	TBA	\$998.00
VM Double Pin Excavator Hitch 60-65mm Pins	TBA	\$1,165.00
Universal Side Shift Heavy Duty	19-9020	\$755.00

Cangini Mulchers



Description	Part Number	RRP
TC1 Mulcher - 800mm - Hammer - 1.5-3.5T	CAN_TC1-80-H	\$8,250.00
TC1 Mulcher - 1000mm - Hammer - 1.5-3.5T	CAN_TC1-100-H	\$8,850.00
TC2 Mulcher - 800mm - Hammer - 3.5-6.5T	CAN_TC2-80-H	\$10,500.00
TC2 Mulcher - 1000mm - Hammer - 3.5-6.5T	CAN_TC2-100-H	\$11,950.00

Cangini Mulcher Wear Parts & Hitches



Description	Part Number	RRP
CAN-TC Double Pin Hitch 30-35mm Pins	TBA	\$702.00
CAN-TC Double Pin Hitch 40-45mm Pins	TBA	\$786.00
CAN-TC Series Teeth	TBA	\$45.00

CONE CRUSHER BUCKETS

Cone Crusher Bucket



Description	Part Number	RRP
Cone Crusher Bucket - TB - HB7 - AT Blue	56-0193050220001	\$9,800.00

Cone Crusher Bucket Hitches & Frames

Description	Part Number	RRP
Cone Crusher Bucket Hitches & Frames	TBA	POA

LOG SPLITTER

Description	Part Number	RRP
Log Splitter to suit 65mm Round Hub	37-1067-KIT	\$1,180.00

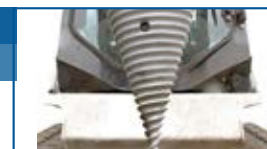

STUMP PLANERS & WEAR PARTS

Description	Part Number	RRP
S4 250mm - 65mm Round Hub	37-025035200	\$1,227.00
S4 350mm - 65mm Round Hub	37-035035200	\$1,499.00
S5 250mm - 75mm Square Hub	37-025035600	\$1,297.00
S5 350mm - 75mm Square Hub	37-035035600	\$1,590.00
Stump Planer Pilot Head Assembly	37-1960	\$298.00
Blades - 250mm Complete Kit	37-9104	\$295.00
Blades - 350mm Complete Kit	37-9105	\$406.00



SPREADER BARS

Size	Part Number	RRP
1100mm x 1000mm	51-1902	\$678.00
1500mm x 1500mm	51-1903-B	\$915.00
2100mm x 1300mm	51-1901-B	\$1,033.00
2100mm x 1800mm	51-1904-B	\$1,550.00



PALLET FORKS

Description	Part Number	RRP
PALLET FORKS - 1500kg (107cm tines) Universal	51-3910-1070	\$1,681.00
PALLET FORKS - 1800kg (122cm tines) Universal	51-3910-1220	\$1,817.00
PALLET FORKS - 1500kg (107cm tines) Euro Hook	51-3912-1070	\$1,681.00
PALLET FORKS - 1800kg (122cm tines) Euro Hook	51-3912-1220	\$1,817.00
PALLET FORKS - 1500kg - Mini Loader 1m wide	51-3946	\$1,360.00
PALLET FORKS - 1500kg - Toyota 1m wide	51-3948-Toyota	\$1,681.00
PALLET FORKS - 1500kg - New Holland 1m wide	51-3948-New Holland	\$1,681.00
PALLET FORKS - 1500kg - ASV RT30/PT30 1m wide	51-3948-ASV RT30/PT30	\$1,681.00
PALLET FORKS - 1500kg - Telehandler 1m wide	51-3948-Telehandler	\$1,681.00



ALUMINIUM RAMPS

Capacity - Length	Overall Width	Weight	Part Number	RRP
1.5 Tonne - 2.8m	400mm	24kg	51-2909	\$1,441.00
3.0 Tonne - 3.5m	425mm	30kg	51-2901	\$1,984.00
4.0 Tonne - 3.5m	450mm	36kg	51-2902	\$2,413.00
4.0 Tonne - 3.9m	450mm	40kg	51-2904	\$2,564.00
4.5 Tonne - 3.5m	520mm	40kg	51-2903	\$2,723.00
4.5 Tonne - 3.9m	520mm	47kg	51-2907	\$2,859.00
5.0 Tonne - 3.5m	555mm	49kg	51-2905	\$2,890.00
6.0 Tonne - 3.5m	610mm	55kg	51-2906	\$3,381.00
8.0 Tonne - 3.5m	610mm	68kg	51-2908	\$4,080.00



DRUM CUTTERS

EXCAVATION DRUM



Description	Part Number	RRP
KDC04 with excavation drum	TBA	TBA
KDC06 with excavation drum	TBA	TBA
KDC08 with excavation drum	TBA	TBA
KDC15 with excavation drum	TBA	TBA
KDC20 with excavation drum	TBA	TBA
KDC30 with excavation drum	TBA	TBA
KDC35 with excavation drum	TBA	TBA
KDC45 with excavation drum	TBA	TBA
KDC60 with excavation drum	TBA	TBA

DEMOLITION DRUM



Description	Part Number	RRP
KDC04 with demolition drum	TBA	TBA
KDC06 with demolition drum	TBA	TBA
KDC08 with demolition drum	TBA	TBA
KDC15 with demolition drum	TBA	TBA
KDC20 with demolition drum	TBA	TBA
KDC30 with demolition drum	TBA	TBA
KDC35 with demolition drum	TBA	TBA
KDC45 with demolition drum	TBA	TBA
KDC60 with demolition drum	TBA	TBA

PROFILING DRUM



Description	Part Number	RRP
KDC04 with profiling drum	TBA	TBA
KDC06 with profiling drum	TBA	TBA
KDC08 with profiling drum	TBA	TBA
KDC15 with profiling drum	TBA	TBA
KDC20 with profiling drum	TBA	TBA
KDC30 with profiling drum	TBA	TBA
KDC35 with profiling drum	TBA	TBA
KDC45 with profiling drum	TBA	TBA
KDC60 with profiling drum	TBA	TBA

AUGER SHAFT ADAPTERS

Description	Part Number	RRP
S2 50mm Rnd F - S4 65mm Rnd M	31-2002	\$291.00
S4 65mm Rnd F - 1 1/8" Hex F	31-5925	\$291.00
S4 65mm Rnd F - S4 2" Hex M	31-4901	\$284.00
S4 65mm Rnd F - S5 57mm Sq M	31-4905	\$314.00
S4 65mm Rnd F - S5 75mm Sq M	31-4907	\$371.00
S4 65mm Rnd F - Bobcat 65mm Rnd M	31-4917	\$284.00
S4 65mm Rnd F - S4 2" Rnd M	31-4910	\$284.00
S4 2" Rnd F - S4 65mm Rnd M	31-4911	\$291.00
S4 2" Hex F - S4 65mm Rnd M	31-4906	\$301.00
S5 2" Hex F - S5 57mm Sq M	31-5905	\$334.00
S5 2" Hex F - S5 75mm Sq M	31-5906	\$394.00
S5 57mm Sq F - S5 2" Hex M	31-5902	\$322.00
S5 57mm Sq F - S4 65mm Rnd	31-5901	\$314.00
S5 57mm Sq F - S5 75mm Sq M	31-5903	\$374.00
S5 75mm Sq F - S5 2" Hex M	31-5917	\$299.00
S5 75mm Sq F - S5 57mm Sq M	31-5908	\$332.00
S5 75mm Sq F - S4 65mm Rnd M	31-5909	\$313.00
S6 75mm Sq F - PA 110mm Sq M	31-6906	\$1,716.00
PA 100mm Sq F - PA 110mm Sq M	31-7910	\$1,722.00
PA 110mm Sq F - S6 75mm Sq M	31-7915	\$1,536.00
PA 110mm Sq F - PA 100mm Sq M	35-7917	\$1,672.00
150mm HEX F - 130mm Sq M	35-7110-130S-FAB	\$1,899.00



Auger Pin & clip supplied in male end

AUGER HUBS

Description	Part Number	RRP
S4 2" Rnd Female	35-4026	\$86.00
S4 2" Hex (73mm) Female	35-4034	\$112.00
S4 2" Hex (88.9mm) Female	35-4033	\$115.00
S4 2" Hex (88.9mm) Male	31-4007	\$112.00
S4 65mm Rnd (73mm) Female	35-4018	\$81.00
S4 65mm Rnd (88.9mm) Female	35-4013	\$78.00
S4 65mm Rnd (88.9mm) Male	31-4009	\$99.00
S5 2" Hex (88.9mm) Female	35-5011	\$115.00
S5 2" Hex (114.3mm) Female	35-5007	\$222.00
S5 57mm Sq (88.9mm) Female	35-5008	\$120.00
S5 57mm Sq (114.3mm) Female	35-5012	\$136.00
S5 57mm Sq (114.3mm) Male	31-5004	\$146.00
S5 75mm Sq Female	35-5010	\$164.00
S5 75mm Sq (114.3mm) Male	31-5007	\$222.00
S5/S6 75mm Sq (73mm) Adaptor Ring	35-5015-73	\$37.00
S5/S6 75mm Sq (88.9mm) Adaptor Ring	35-5015-89	\$37.00
S6 75mm Sq (114.3mm) Female	35-6008	\$263.00
S6 75mm Sq (141.3mm) Female	35-6034	\$267.00
S6 75mm Sq (141.3mm) Male	31-6006	\$361.00
PA 100mm Sq Hub Female	35-7081	\$952.00
PA 100mm Sq Hub Male	31-7028	\$593.00
PA 110mm Sq Hub Female	35-7079	\$952.00
PA 110mm Sq Hub Male	31-7030	\$691.00



Male components come with Auger Pin & clip supplied

HYDRAULIC COUPLERS



Description (Thread)	Part Number	RRP
3/8" Flat Face (3/8" BSP)	99-7050-M/F	\$173.00
3/8" Flat Face (1/2" BSP)	99-7051-M/F	\$173.00
1/2" ISO/Poppet (1/2" BSP)	99-7055-M/F	\$77.00
1/2" Flat Face (1/2" BSP)	99-7052-M/F	\$186.00
1/2" Flat Face (3/4" BSP)	99-7053-M/F	\$221.00
5/8" Flat Face (3/4" BSP)	99-7054-M/F	\$268.00
3/4" ISO/Poppet (3/4" BSP)	99-7057-M/F	\$126.00
3/4" Flat Face (3/4" BSP)	99-7056-M/F	\$322.00
1" Flat Face (1" BSP)	99-7060-M/F	\$376.00

HYDRAULIC HOSES



Length/Type	Part Number	RRP
Set of 1.4m 1/2" 90°	99-7501-KIT	\$186.00
Set of 1.4m 1/2" Straight	99-7502-KIT	\$173.00
Set of 1.8m 1/2" 45°	99-7527-KIT	\$202.00
Set of 1.8m 1/2" 90°	99-7503-KIT	\$202.00
Set of 1.8m 1/2" Straight	99-7504-KIT	\$184.00
Set of 2.2m 1/2" 90°	99-7505-KIT	\$220.00
Set of 2.2m 1/2" Straight	99-7506-KIT	\$201.00
Set of 2.8m 1/2" Straight	99-7522-KIT	\$266.00
Set of 2.2m 3/4" 90°	99-7602-KIT	\$327.00
Set of 2.2m 3/4" Straight	99-7601-KIT	\$322.00
Set of 2.2m 1" Straight	99-7701-KIT	\$719.00

LINK BLOCKS, PINS & CLIPS



Description	Part Number	RRP
S2 & 2" Agricultural Pin	30-0001-KIT	\$27.00
S4 2" Hex Pin	30-0003-KIT	\$33.00
S4 65mm Rnd Pin	30-0004-KIT	\$31.00
S5/S6 75mm Sq Pin	30-0002-KIT	\$33.00
PA 110mm Sq Pin	23-3900-KIT	\$70.00
30mm Hood Pin	23-2904-KIT	\$70.00
45mm Hood Pin	23-4016-KIT	\$72.00
60mm Hood Pin	23-5008	\$112.00
Trench Cleaner Pin	42-9001	\$27.00
Auger Lynch Pin	99-99020	\$6.00
Earth Drill 1200 Link Block	11-0013	\$94.00
Link Block 75mm Sq (30mm Ø Pin)	11-0010-KIT	\$98.00
Link Block 100mm Sq (45mm Ø Pin)	11-0014-KIT	\$290.00
Link Block 110mm Sq (60mm Ø Pin)	11-0007-KIT	\$539.00
Hood Ear - 30mm Hole RHS (X1500 - X2500)	23-2011	\$25.00
Hood Ear - 30mm Hole LHS (X1500 - X2500)	23-2012	\$25.00
Hood Ear - 30mm Hole LHS (2500 - 8000MAX)	23-3009	\$29.00
Hood Ear - 30mm Hole RHS (2500 - 8000MAX)	23-3010	\$29.00
Hood Ear - 45mm Hole (10000-25,000MAX)	23-4014	\$112.00

THE KINSHOFER GROUP

GLOBAL EXPERTISE



The Kinshofer Group of Companies

As a collective group of specialist attachment companies, the Kinshofer Group has one of the most diverse specialist product offerings available anywhere around the world today. Our global expertise is what sets our closely-knit family of manufacturers apart from the rest.

We are large enough together to provide you with unrivalled product know-how while at the same time being nimble enough to discuss your unique requirements in an open and personal way.



13 22 12

Proudly Distributed By

LOCAL KNOW-HOW

Call us today on our National number for your nearest distributor or dealer.



YOUR NEAREST DEALER IS

Auger Torque Australia / Pacific Region

Auger Torque Australia Pty Ltd

Brisbane & Melbourne

National Number 13 22 12

Email: sales@augertorque.com.au

Products and specifications subject to change without prior notice.

Some products may not be available in your country or region.

AUGER TORQUE, SHOCK LOCK™, NDS™ and the AUGER TORQUE LOGO are trademarks of Auger Torque Europe Ltd © 2023 Auger Torque Europe Ltd. All Rights Reserved.

